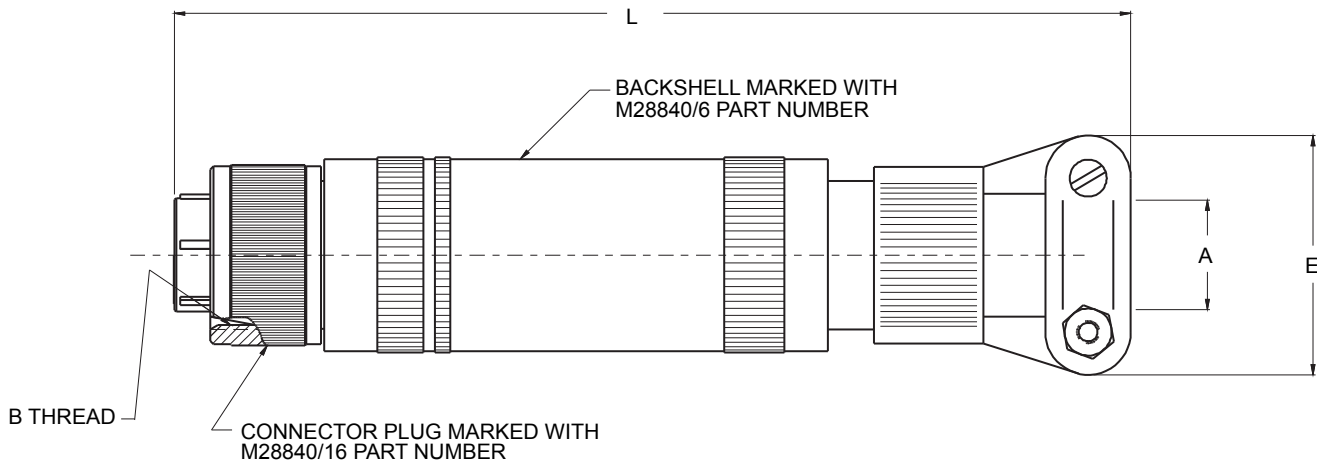

HOW TO ORDER:

GLENNAIR P/N:	901-026	NF	25	1	A -	A	P	1	
MILITARY P/N:	M28840/26	C	G	1	A	A	P	1	
	BASIC PART NUMBER								KEY POSITION (SEE MIL-C-28840)
③	CLASS CODE (SEE MIL-C-28840)								CONTACT STYLE (SEE MIL-C-28840)
	SHELL SIZE (TABLE I)								BACKSHELL STYLE (SEE MIL-C-28840)
	INSERT ARRANGEMENT (SEE MIL-C-28840)								BACKSHELL SIZE DESIGNATOR (SEE ABOVE)

NOTES:

1. INTERPRET PER MIL-STD-100.
2. SEE MIL-C-28840 FOR ADDITIONAL DESIGN DETAILS.
- ③ GLENNAIR NF = CLASS C
GLENNAIR ZU = CLASS E
4. BAG AND TAG WITH M28840/26 PART NUMBER

901-026
 Plug, Straight, Adapter Assembly
 MIL-C-28840/26



MIL-C-28840

TABLE I: CONNECTOR DIMENSIONS

MILLITARY SHELL SIZE	SHELL SIZE	B THREAD CLASS 2B	BACKSHELL			E MAX.	L MAX.
			SIZE DESIGNATOR	A CABLE ENTRY			
				OPEN	CLOSED		
A	11	.750-.1P-.2L-D.S.	A	.312 (7.9)	.188 (4.8)	.938 (23.8)	6.500 (165.1)
			B	.438 (11.1)	.281 (7.1)	1.125 (28.6)	
			C	.562 (14.3)	.344 (8.7)	1.312 (33.3)	
B	13	.875-.1P-.2L-D.S.	B	.438 (11.1)	.281 (7.1)	1.125 (28.6)	6.500 (165.1)
			C	.562 (14.3)	.344 (8.7)	1.312 (33.3)	
			D	.625 (15.9)	.375 (9.5)	1.593 (40.5)	7.000 (177.8)
C	15	1.062-.1P-.2L-D.S.	A	.438 (11.1)	.281 (7.1)	1.125 (28.6)	6.500 (165.1)
			B	.562 (14.3)	.344 (8.7)	1.312 (33.3)	
			C	.625 (15.9)	.375 (9.5)	1.593 (40.5)	
D	17	1.125-.1P-.2L-D.S.	A	.625 (15.9)	.375 (9.5)	1.312 (33.3)	7.000 (177.8)
			B	.750 (19.1)	.438 (11.1)	1.593 (40.5)	
			C	.875 (22.2)	.500 (12.7)	1.875 (47.6)	
E	19	1.312-.1P-.2L-D.S.	A	.625 (15.9)	.375 (9.5)	1.312 (33.3)	7.000 (177.8)
			B	.938 (23.8)	.625 (15.9)	1.750 (44.5)	
F	23	1.500-.1P-.2L-D.S.	A	.750 (19.1)	.438 (11.1)	1.593 (40.5)	7.500 (190.5)
			B	.938 (23.8)	.625 (15.9)	1.750 (44.5)	7.625 (193.7)
			C	1.188 (30.2)	.812 (20.6)	2.093 (53.2)	7.812 (198.4)
G	25	1.625-.1P-.2L-D.S.	A	.938 (23.8)	.625 (15.9)	1.750 (44.5)	7.625 (193.7)
			B	1.188 (30.2)	.812 (20.6)	2.093 (53.2)	
			C	1.250 (31.8)	.875 (22.2)	2.343 (59.5)	
H	29	1.812-.1P-.2L-D.S.	A	1.188 (30.2)	.812 (20.6)	2.093 (53.2)	8.312 (211.1)
			B	1.380 (35.1)	1.000 (25.4)	2.343 (59.5)	
			C	1.625 (41.3)	1.250 (31.8)	2.750 (69.9)	
J	33	2.000-.1P-.2L-D.S.	A	1.380 (35.1)	1.000 (25.4)	2.343 (59.5)	8.625 (219.1)
			B	1.625 (41.3)	1.250 (31.8)	2.750 (69.9)	